

2002-2005 Preschool Facility Plan

As of September 2002: Note: New construction sites may change as a result of changing demographics in school neighborhoods.

School Site	Existing Classroom Space		Modernization	New Construction	
	Current Program	Plan to Open		Planned	Funding Source
Allen		1 room Parent Participation-			
Almaden	1 room- State Preschool			4 rooms	San Jose Smart Start \$650,000 Note: will not use Measure F funds.
Bachrodt	4 rooms Child Dev. Center		4 existing rooms Measure F		
Booksin		1 room Parent Participation-			
Canoas	2 rooms State Preschool				
Carson		1 room Parent Participation-			
Cory	4 rooms Child Dev. Center		4 existing rooms Measure F		
Anne Darling	1 room State Preschool				
Empire Gardens	1 room State Preschool				
Erikson (Family Early Learning Center)				1 room State Preschool	Measure F
Galarza				2 rooms State Preschool Parent Participation	Measure F
Gardner	1 room State Preschool			2 rooms Parent Participation State Preschool	Measure F
Grant	1 room State Preschool			1 room State Preschool	Measure F
Graystone		1 room Parent Participation-			
Hacienda	1 room State Preschool				
Hammer	1 room Magnet Program				
Hester		1 room Parent Participation-			
Los Alimitos				1 room Parent Participation	Measure F
Lowell	1 room Parent Participation			2 rooms State Preschool Parent Participation	Measure F
Horace Mann		1 room State Preschool			
Olinder	1 room State Preschool	1 room Parent Participation			
Randol		1 room Parent Participation-			
Reed		1 room Parent Participation-			
River Glen	1 room State Preschool				
Schallenberger		1 room Parent Participation-			
Slmonds				1 room Parent Participation	Measure F
Terrell		1 room Parent Participation-			
Trace	1 room State Preschool				
Washington (Family Early Learning Center)	2 rooms State Preschool				
Williams				1 room Parent Participation	Measure F
Willow Glen Elem.				1 room Parent Participation	Measure F
24 th & Julian- Family Early Learning Center				Preschool Facility	San Jose Smart Start \$500,000 Santa Clara COE \$1,000,000 Measure F
	Total Preschool Sites: 15		Total Measure F: see attached sheet		

State Preschool: Part-day comprehensive development program for 3-5 year old children from low income families. Funded through Ca. Dept. of Education (CDE) and administered by SJUSD
Child Development Center: Full-day comprehensive development program for 3-5 year old children from low income families Funded through CDE and administered by SJUSD
Parent Participation Preschool: Part-time, part day comprehensive development program for 18mo.-5 year old children. Funded through the CDE , parent fees and First 5 and administered by Metropolitan Education District (Adult Ed.)
Head Start: Full-day comprehensive development program for 3-5 year old children from low income families Federally funded and administered by Santa Clara Co. Office of Educaiton.

San Jose Unified School District						
Preschool Facilities						
September 16, Rev., Formatted for distribution.						
Notes:						
1. Assessment performed by SJUSD Facilities Dept.						
2. Cost models developed from actual costs incurred from similar work.						
	Hard	Soft	Contingency	2001 Cost		Total Cost
School Site	Cost	Cost	20%	Unescalated	Year	Escalated
Allen		\$0	\$0	\$0		\$0
Almaden	\$92,520	\$24,980	\$23,500	\$141,000	1	\$141,000
Bachrodt	\$65,617	\$17,717	\$16,667	\$100,000	2	\$105,000
Booksin		\$0	\$0	\$0		\$0
Canoas		\$0	\$0	\$0		\$0
Carson		\$0	\$0	\$0		\$0
Cory	\$65,617	\$17,717	\$16,667	\$100,000	2	\$105,000
Anne Darling		\$0	\$0	\$0		\$0
Empire Gardens		\$0	\$0	\$0		\$0
Erikson	\$92,520	\$24,980	\$23,500	\$141,000	1	\$141,000
Galarza	\$164,042	\$44,291	\$41,667	\$250,000	1	\$250,000
Gardner	\$164,042	\$44,291	\$41,667	\$250,000	2	\$262,500
Grant	\$92,520	\$24,980	\$23,500	\$141,000	3	\$155,453
Graystone		\$0	\$0	\$0		\$0
Hacienda		\$0	\$0	\$0		\$0
Hammer		\$0	\$0	\$0		\$0
Hester		\$0	\$0	\$0		\$0
Los Alamitos	\$92,520	\$24,980	\$23,500	\$141,000	3	\$155,453
Lowell	\$164,042	\$44,291	\$41,667	\$250,000	1	\$250,000
Horace Mann		\$0	\$0	\$0		\$0
Olinder		\$0	\$0	\$0		\$0
Randol		\$0	\$0	\$0		\$0
Reed		\$0	\$0	\$0		\$0
River Glen		\$0	\$0	\$0		\$0
Schallenberger		\$0	\$0	\$0		\$0
Simonds	\$92,520	\$24,980	\$23,500	\$141,000	3	\$155,453
Terrell		\$0	\$0	\$0		\$0
Trace		\$0	\$0	\$0		\$0
Washington		\$0	\$0	\$0		\$0
Williams	\$92,520	\$24,980	\$23,500	\$141,000	3	\$155,453
Willow Glen ES	\$92,520	\$24,980	\$23,500	\$141,000	3	\$155,453

Burnett Middle		\$0	\$0	\$0		\$0
Castillero Middle		\$0	\$0	\$0		\$0
Bret Harte Middle		\$0	\$0	\$0		\$0
Hoover Middle		\$0	\$0	\$0		\$0
John Muir Middle		\$0	\$0	\$0		\$0
Steinbeck Middle		\$0	\$0	\$0		\$0
Willow Glen Middle		\$0	\$0	\$0		\$0
Broadway Cont. High		\$0	\$0	\$0		\$0
Crossroads High		\$0	\$0	\$0		\$0
Downtown College Prep		\$0	\$0	\$0		\$0
Gunderson High		\$0	\$0	\$0		\$0
Leland High		\$0	\$0	\$0		\$0
Liberty High		\$0	\$0	\$0		\$0
Lincoln High		\$0	\$0	\$0		\$0
Pioneer High		\$0	\$0	\$0		\$0
San Jose High		\$0	\$0	\$0		\$0
Willow Glen High		\$0	\$0	\$0		\$0
District Facilities	\$5,100,000	\$1,377,000	\$1,295,400	\$7,772,400	1	\$7,772,400
Totals	\$6,371,000	\$1,720,170	\$1,618,234	\$9,709,404		\$9,804,167

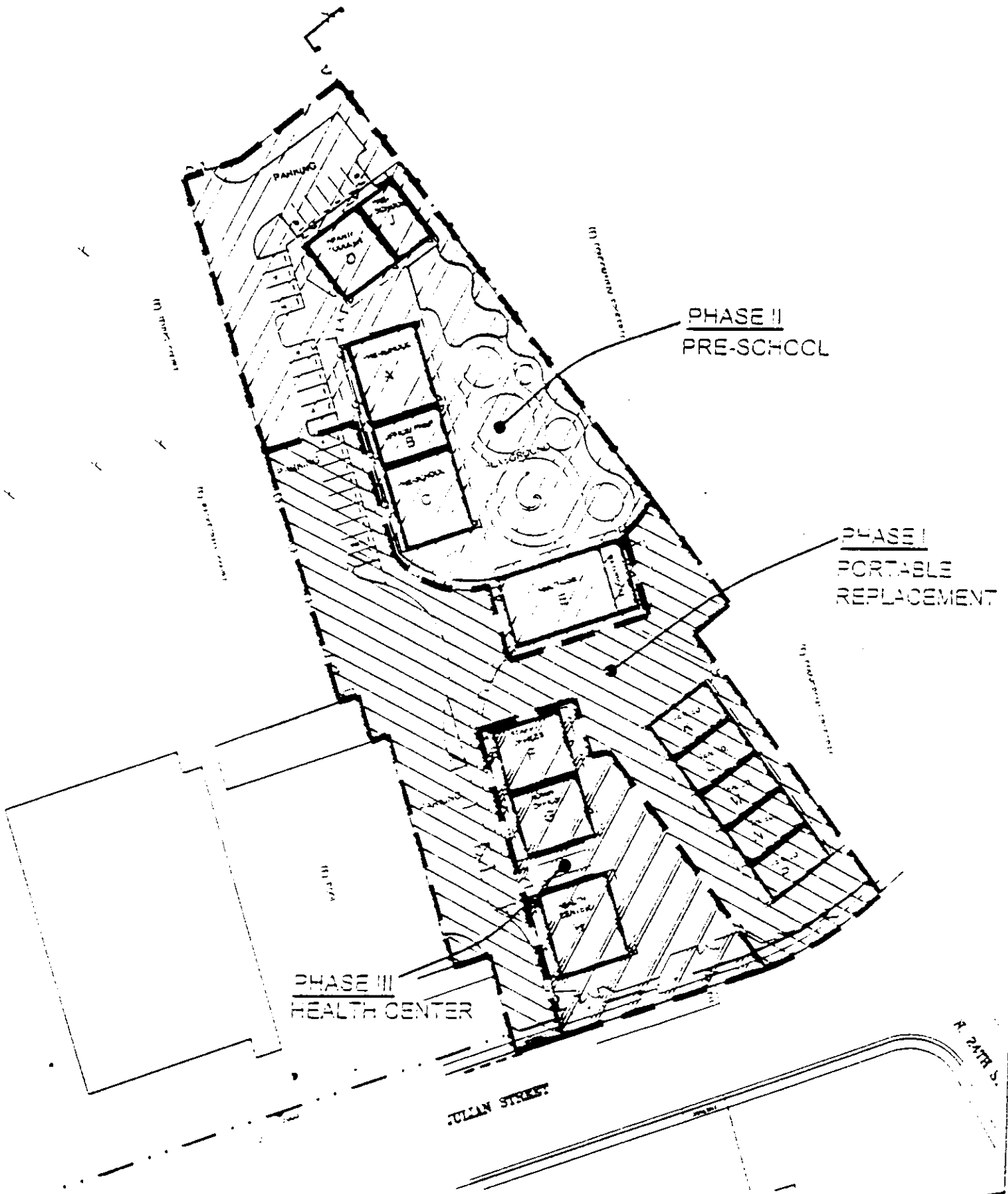

PHASE III
HEALTH CENTER

PHASE II
PRE-SCHOOL

PHASE I
PORTABLE
REPLACEMENT

JULIAN STREET

R. 24TH ST.



BILL GOULD DESIGN
ART & ARCHITECTURE
13107-P 4180 CENTER BLVD

SITE PLAN

FAMILY EARLY LEARNING CENTER
1149 E. JULIAN ST.

SCALE	1"=80'-0"
PROJECT NO	05761
DATE	10.15.02